



Cyclemaster™ Bollard

Installation and Maintenance Instructions

IMPORTANT NOTE: ENSURE THAT ALL RELEVANT PERSONNEL READ THESE INSTRUCTIONS PRIOR TO USE

Please also refer to the 'Manual Handling Operations Regulations 1992' during the handling of the product and materials used for installation. Glasdon recommends that a full Health and Safety analysis is carried out prior to installation.

A

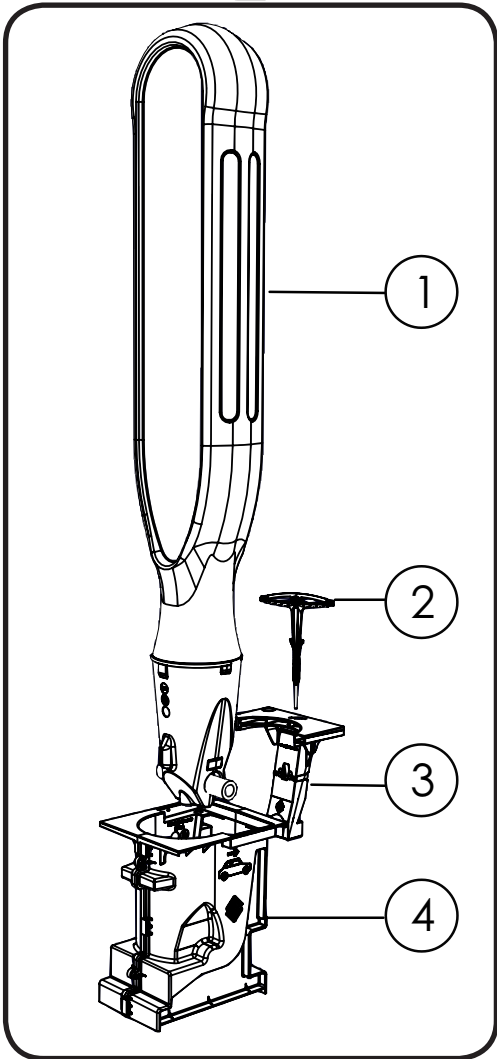

B

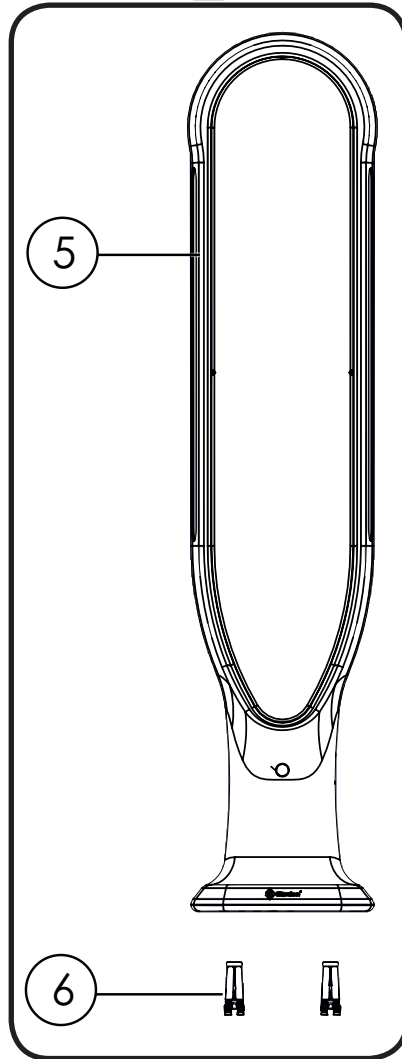

C

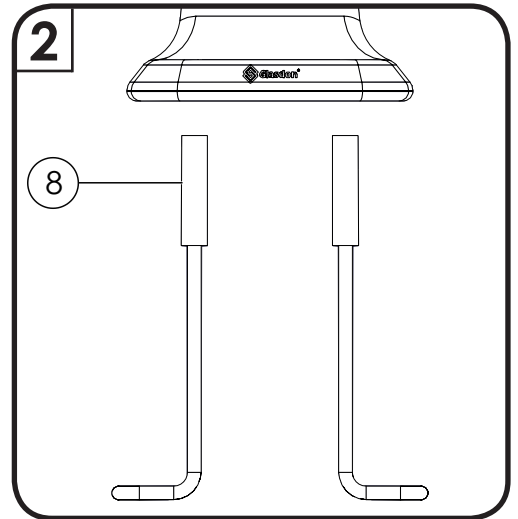
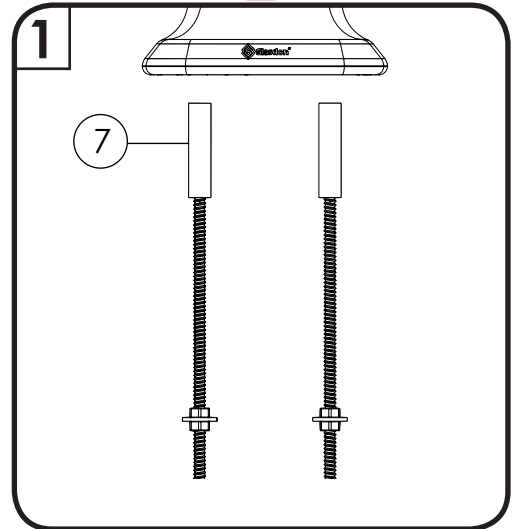

A

C



A

C

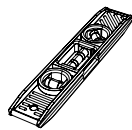

A

C

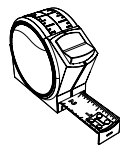

A

C



A

B

C



B

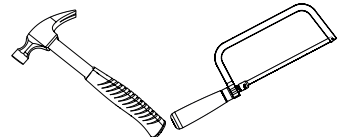

B

C

C

SOCKET INSTALLATION

A

1.

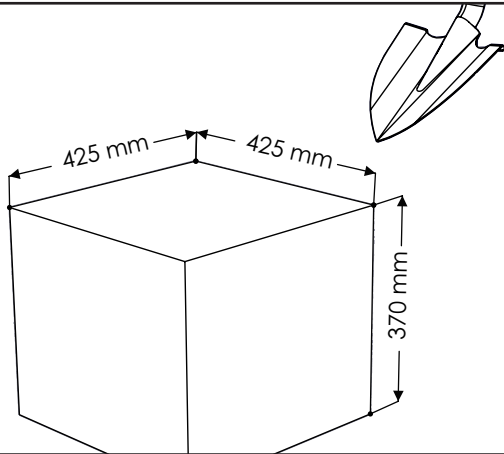

2.

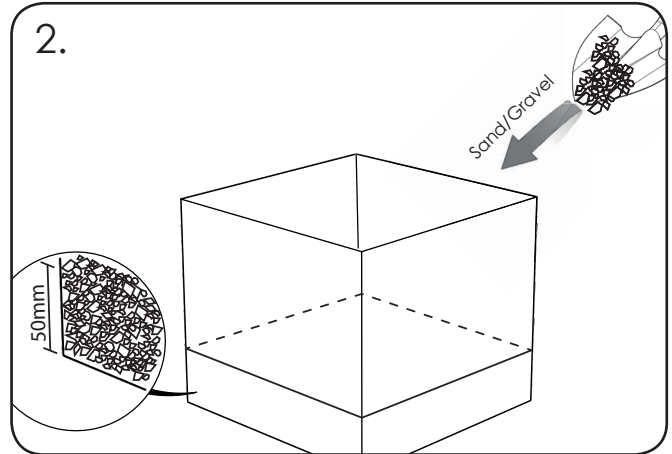

3.

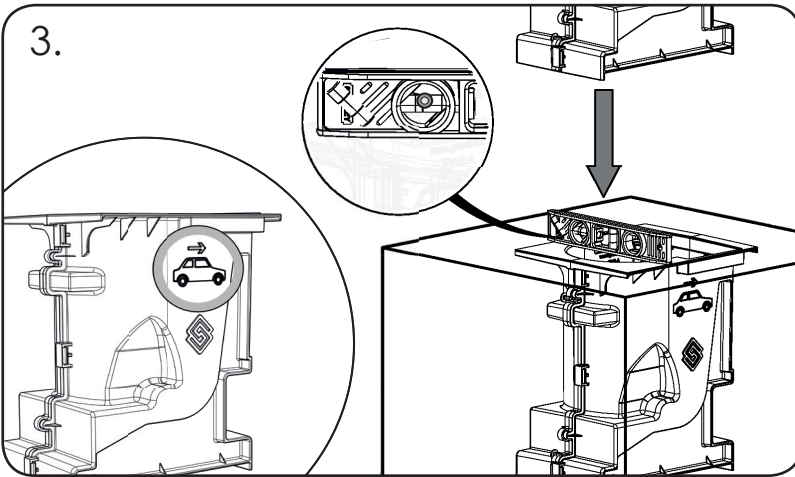

The socket should be installed with the traffic direction indicators pointing in the direction of traffic on the nearside of the carriageway.

4.

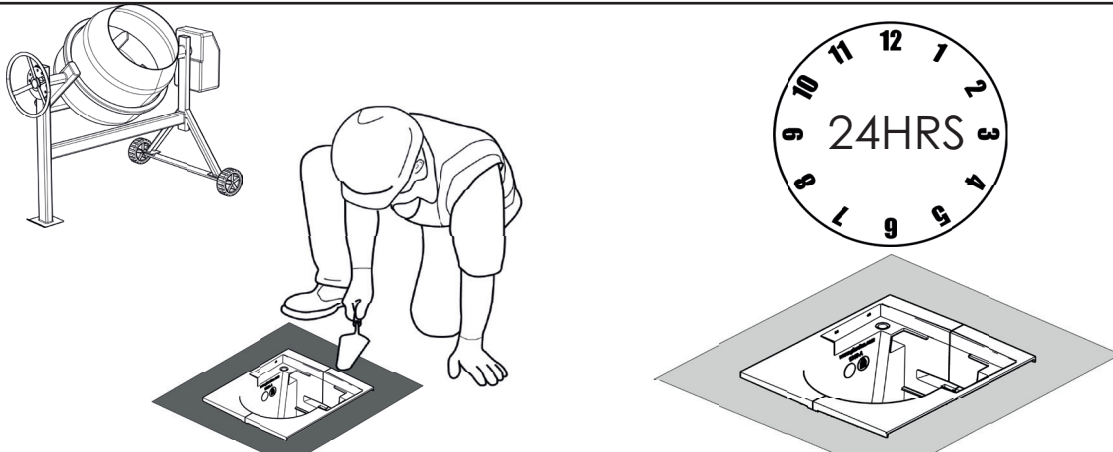

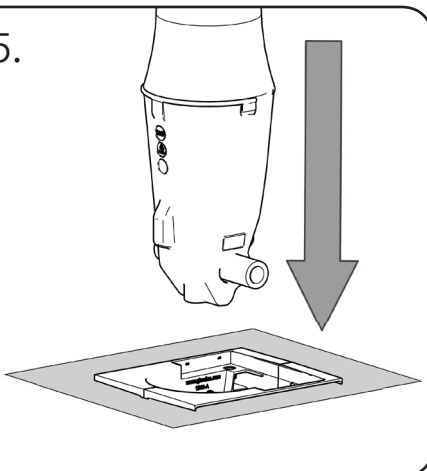

5.

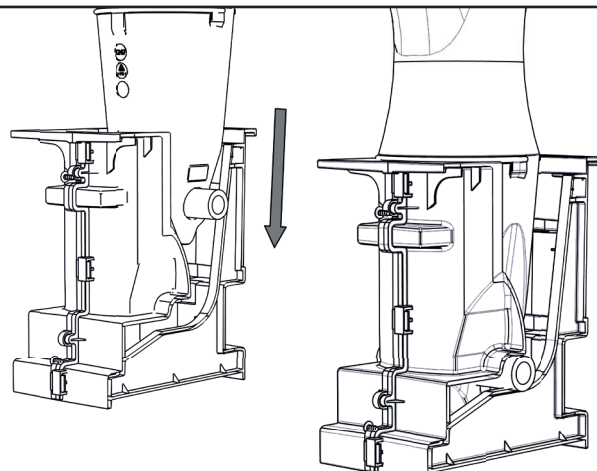

6.

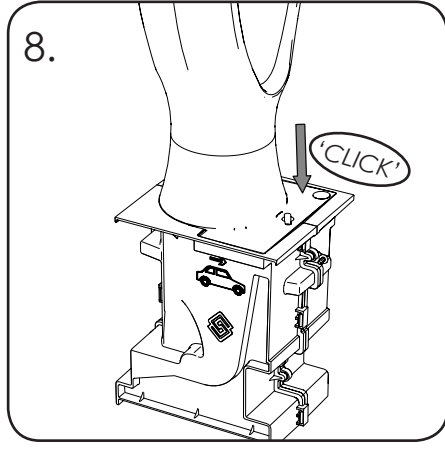
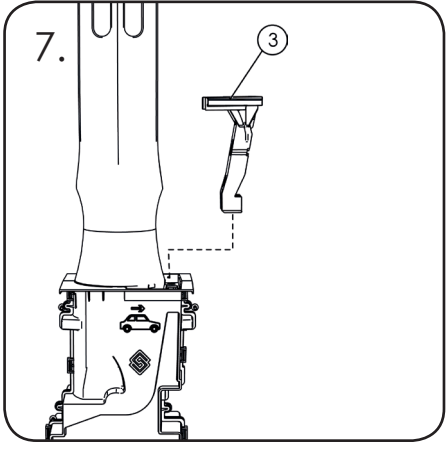



 Test the bollard is secure by attempting to lift from the socket.

REMOVE SOCKET PLUG

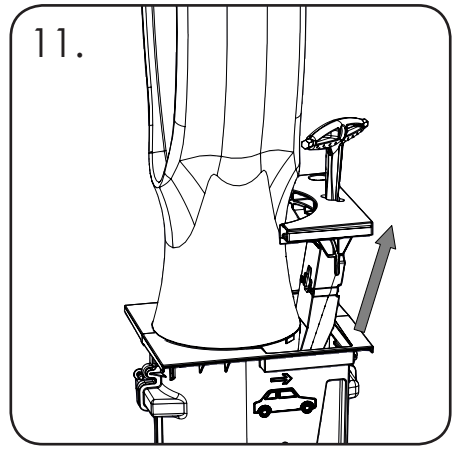
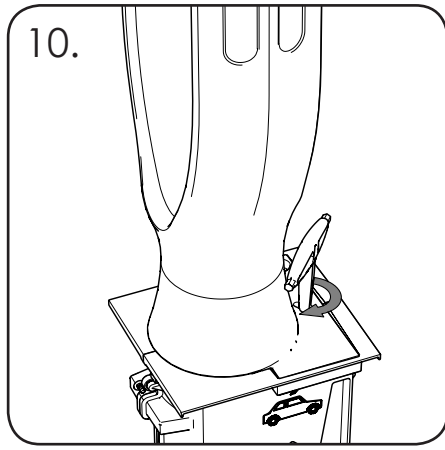
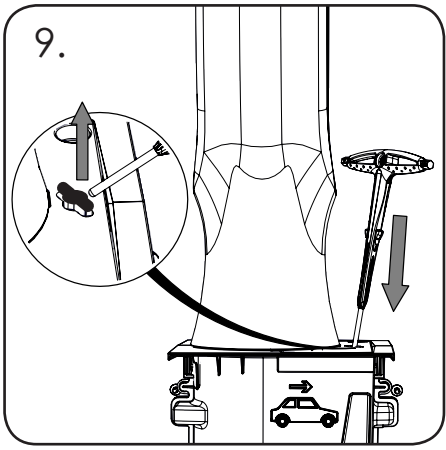

BOLT-DOWN FIXING INSTALLATION **B**

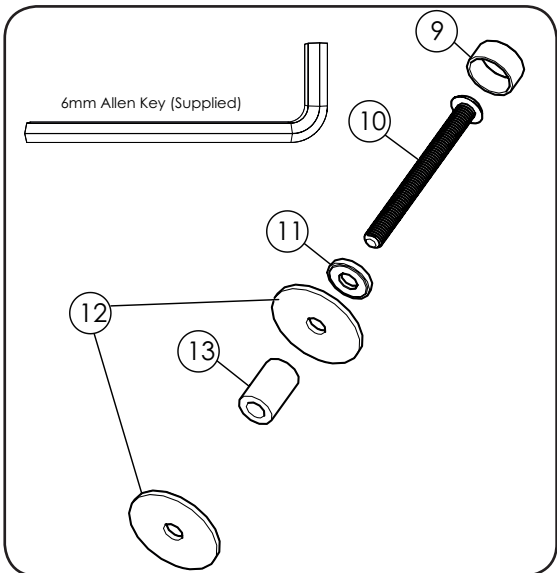

- (6) x 4
- (9) x 4
- (10) x 4
- (11) x 4
- (12) x 8
- (13) x 4

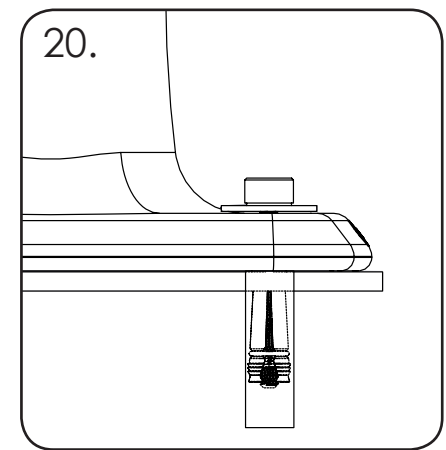
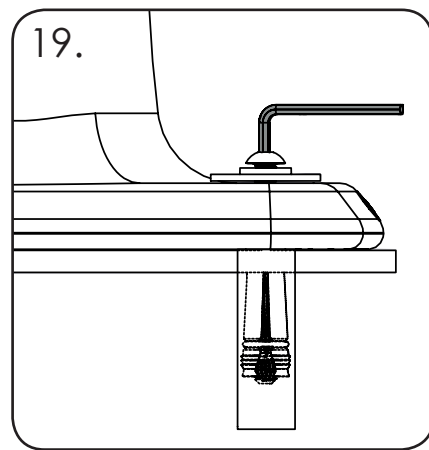
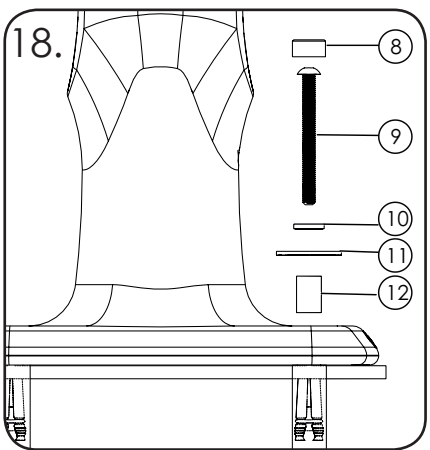
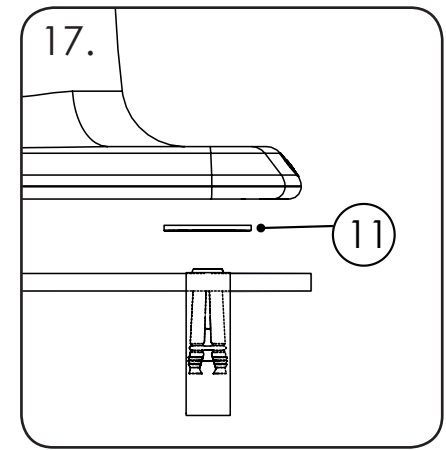
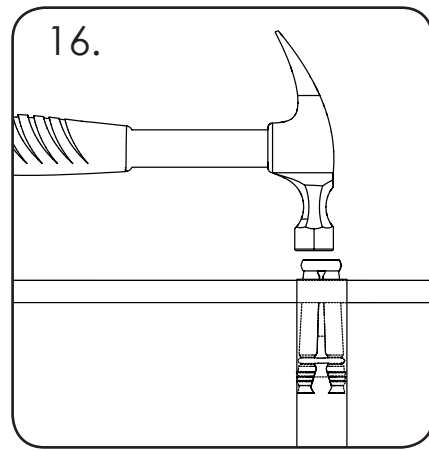
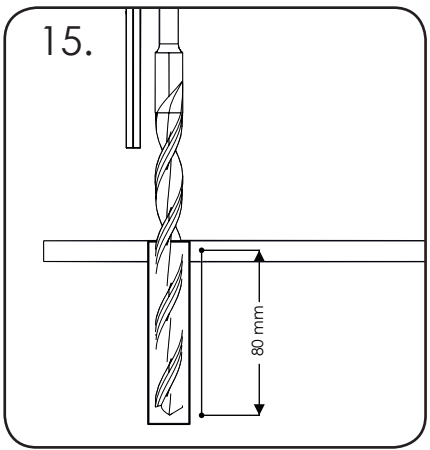
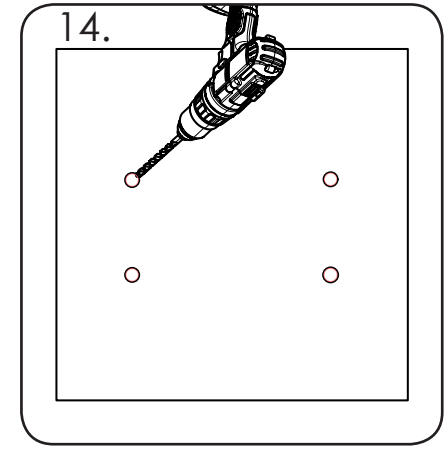
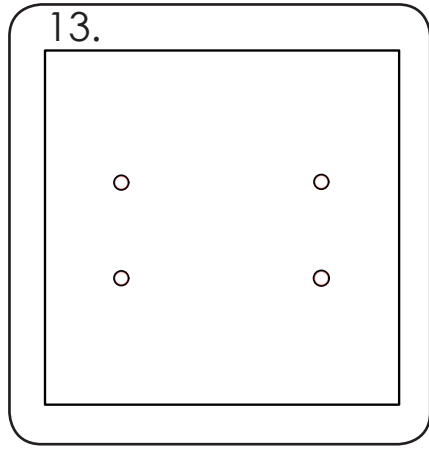
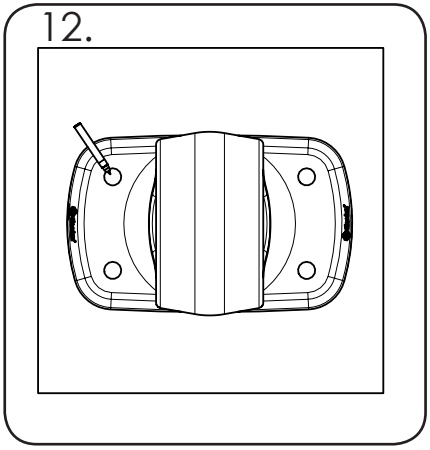
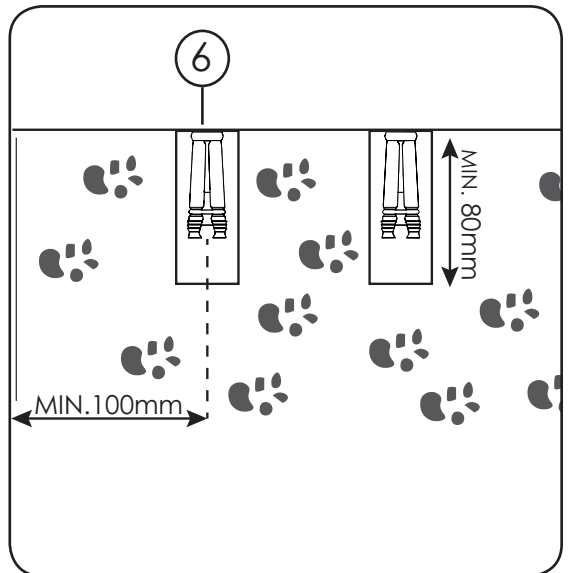

ADJUSTABLE DEPTH FIXING INSTALLATION **C1**

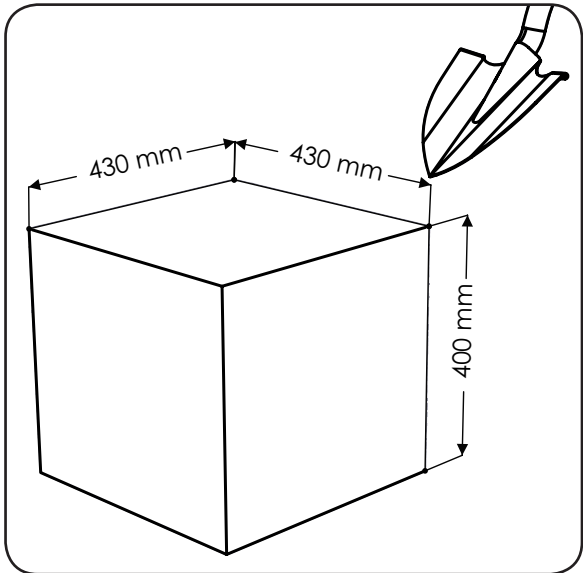

- 7 x 4
- 9 x 4
- 10 x 4
- 11 x 4
- 12 x 8
- 13 x 4

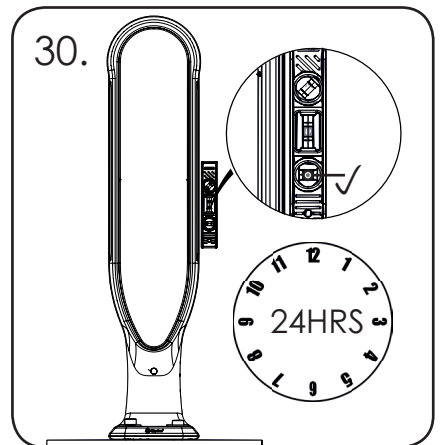
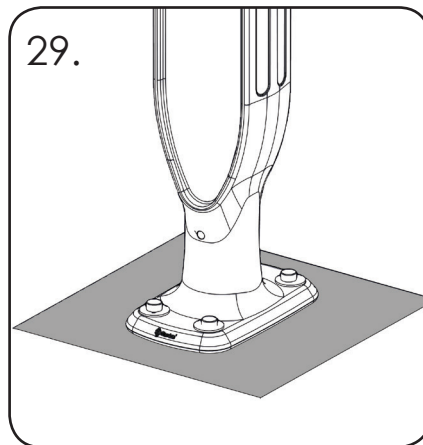
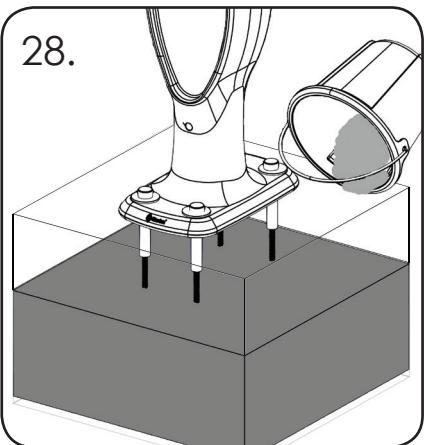
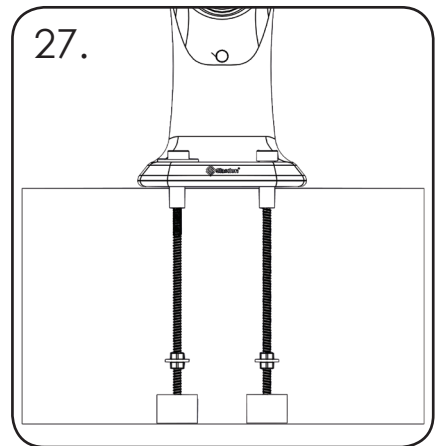
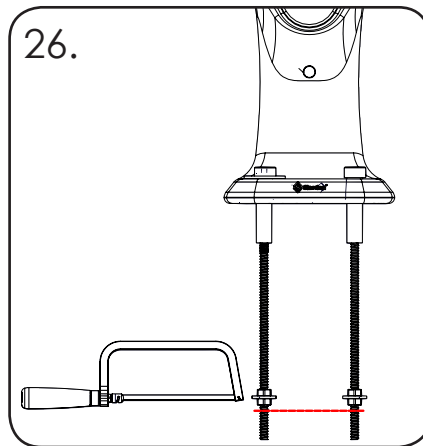
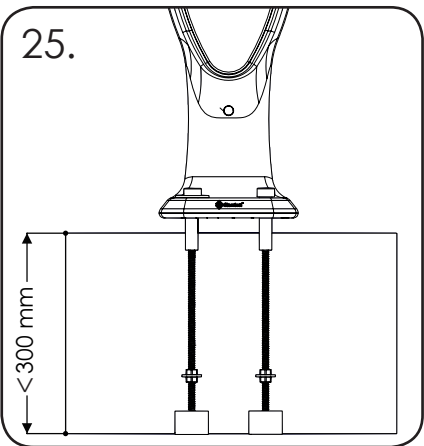
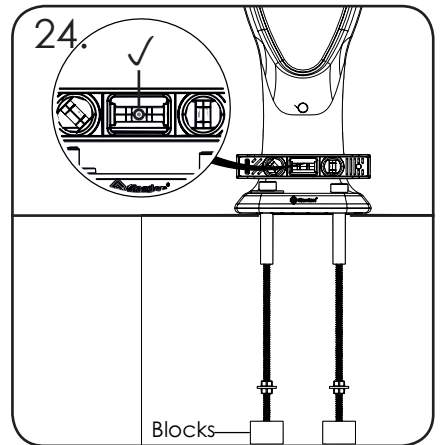
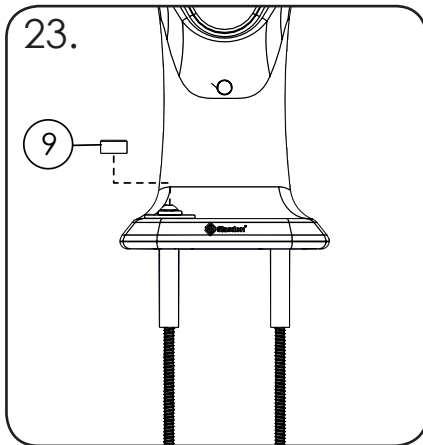
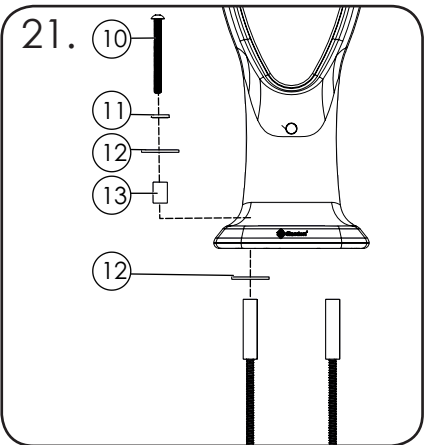
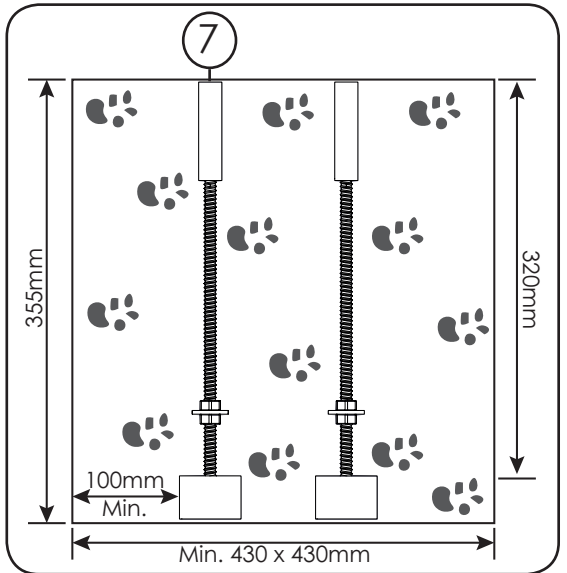

FIXED DEPTH INSTALLATION **C2**

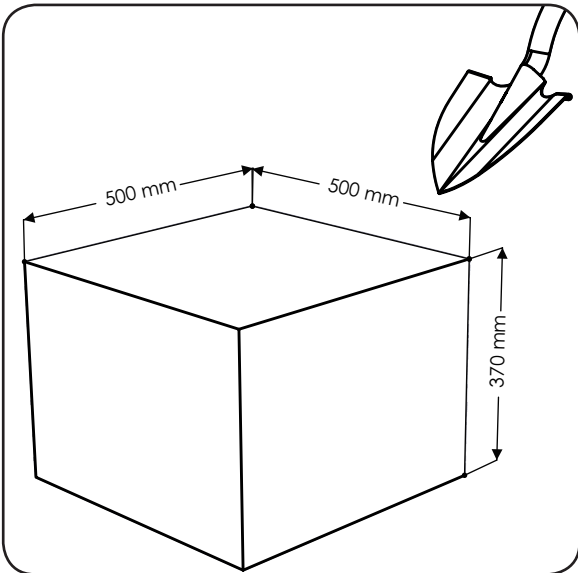

- 8 x 2
- 9 x 4
- 10 x 4
- 11 x 4
- 12 x 8
- 13 x 4

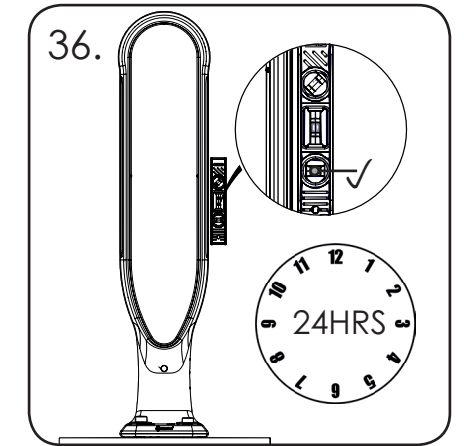
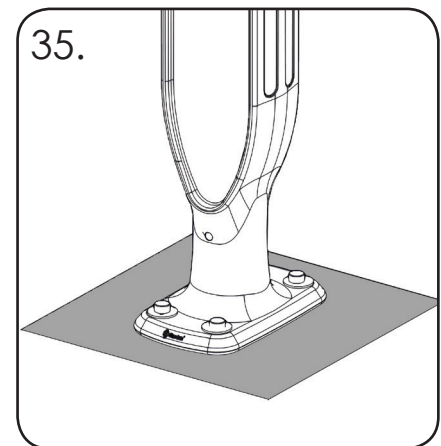
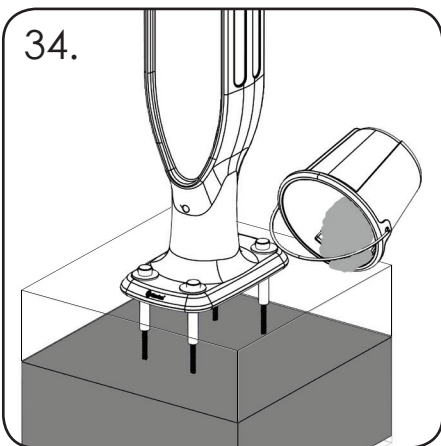
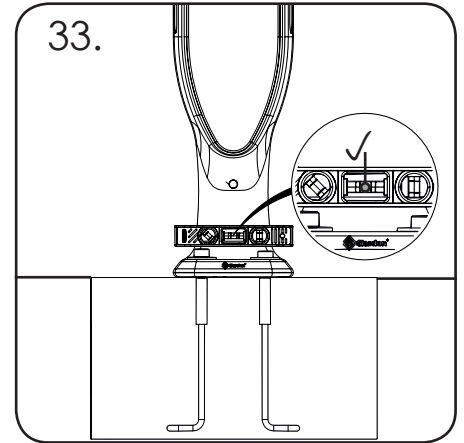
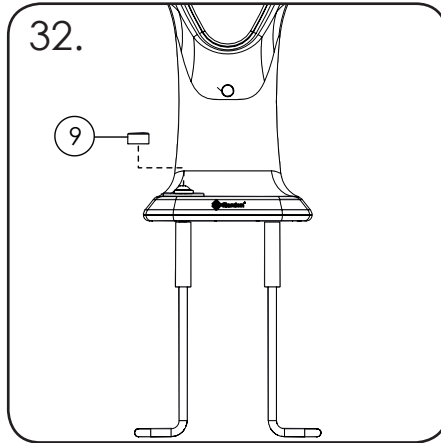
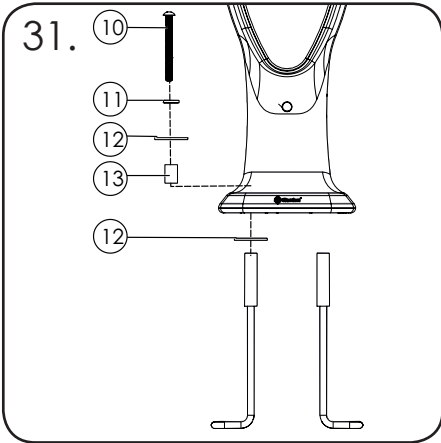
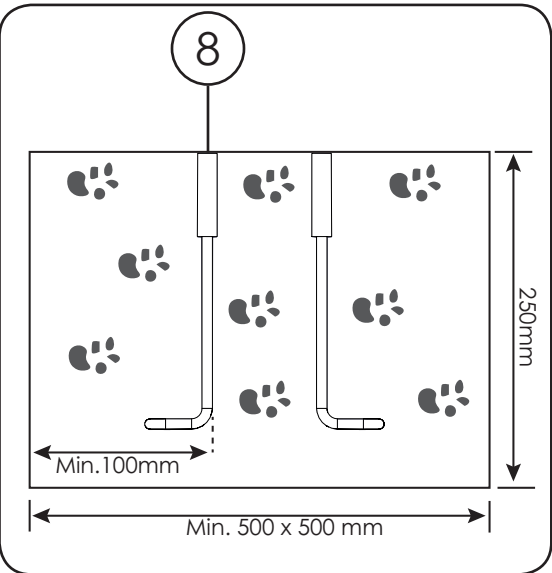

CONCRETE-IN INSTALLATION

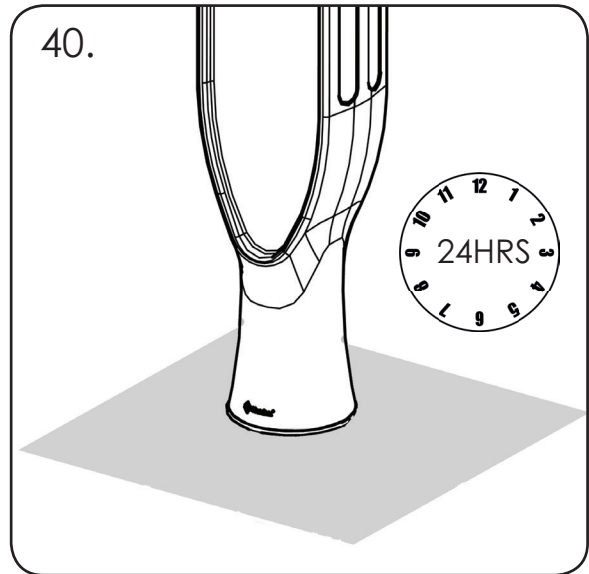
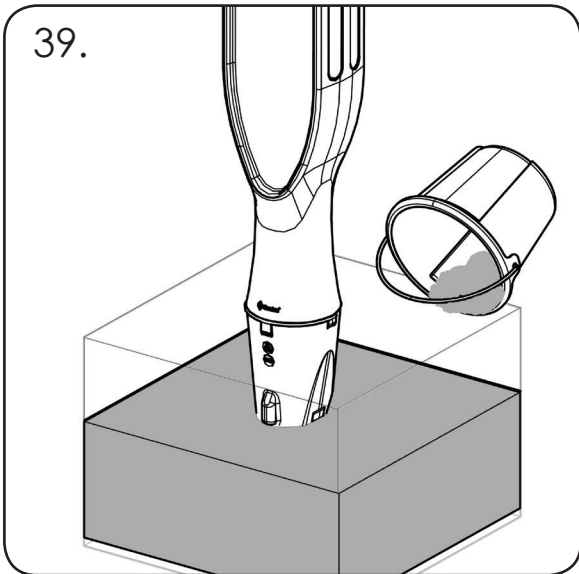
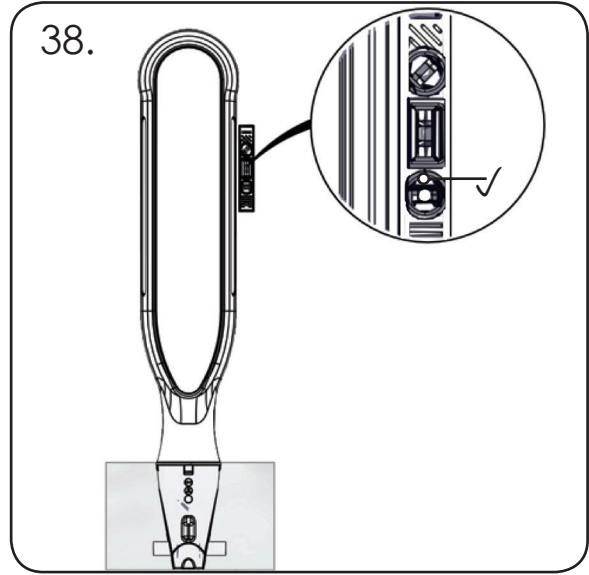
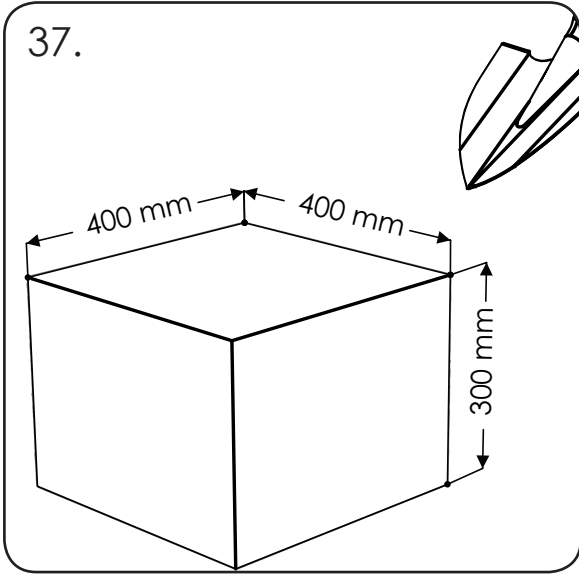

IMPORTANT NOTE: PLEASE ENSURE THAT ALL RELEVANT PERSONNEL READ THE POINTS LISTED WITHIN THIS LEAFLET AND THAT A COPY IS GIVEN TO STAFF INVOLVED WITH THE INSTALLATION AND MAINTENANCE OF THIS PRODUCT.
SAFETY NOTE: PLEASE REFER TO 'THE MANUAL HANDLING OPERATIONS REGULATIONS 1992' DURING HANDLING.

 **Glasdon** AND CYCLEMASTERTM ARE TRADEMARKS OR REGISTERED TRADEMARKS OF GLASDON GROUP OR ITS SUBSIDIARIES IN THE U.K. AND OTHER COUNTRIES

- A planned maintenance schedule or regular inspection is recommended, replacing components as necessary.
- Replacement components are available direct from GLASDON.
- GLASDON cannot be held responsible for claims arising from incorrect installation, unauthorised modifications or misuse of the product.

Stock No. C000/0527 - DWG No. 02B089-05 Issue 1 - August 2019

© Copyright August 2019

Glasdon UK Ltd reserve the right to alter specifications without prior notice.

 **Glasdon®**
Glasdon U.K. Limited
Preston New Road
BLACKPOOL
Lancashire
FY4 4UL
Tel: (01253) 600410
Fax: (01253) 792558
e-mail: sales@glasdon-uk.co.uk
web: www.glasdon.com